

REV	LOCATIONS	DESCRIPTION	DATE	REVISER	APPD

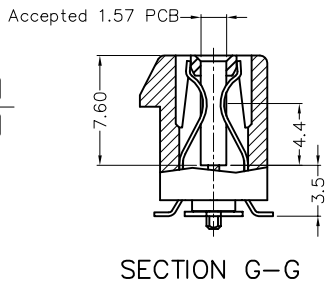
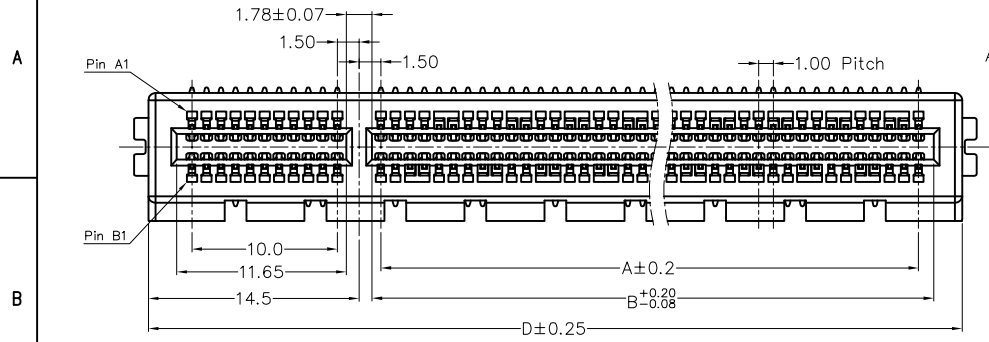

SPECIFICATIONS

Electrical
 Current Rating: 1.1A AC(rms)/DC
 Voltage Rating: 50V AC(rms)/DC
 Contact Resistance: 30mΩ Max
 Insulation Resistance: 1000MΩ Min
 Withstanding Voltage: 500V AC r.m.s
 Temperature Range-Operating: -40°C ~ +85°C

Material
 Housing: PA9T (UL 94V-0) Black
 Contact: Phosphor bronze/ Selected gold plated on contact area, 100u" Min. matte Tin plated on solder tails
 Holddown: Copper Alloy/ 100u" Min. matte Tin Plated

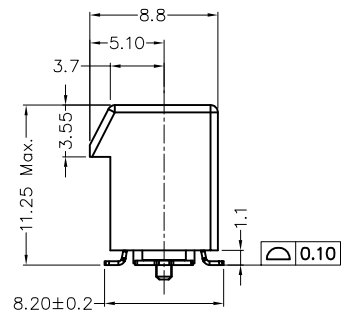
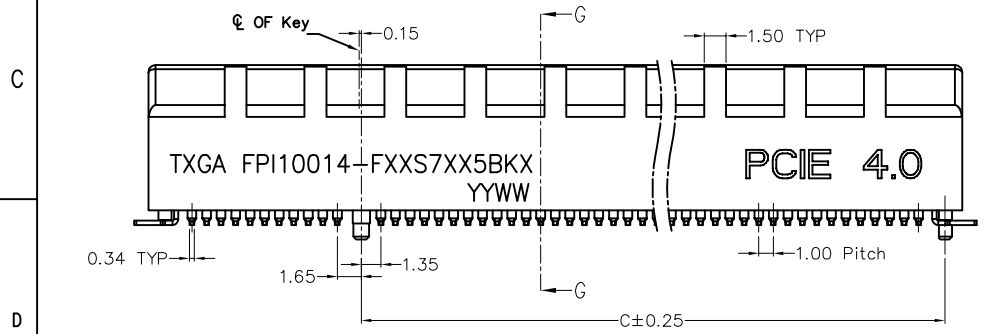

Ordering Information

FPI 100 14 - F XX S 7 XX 5 BK X
 1 2 3 4 5 6 7 8 9 10 11

1	Category FPI-PCIE	2	Series Number 100-Pitch1.00mm	3	Distinction No. 14	4	Type F-Female	5	Circuits XX	6	Entry Angle S-180° Vertical
7	Plating 7-Selective gold plated on contact area and matte tin plated on tails area	8	Thickness of Plating 00-Gold Flash 15-0.375µm 30-0.75µm	9	Material-Resin 5-PA9T	10	Color-Resin BK-Black	11	Packaging K-Tray M-Reel with cap W-Reel with mylar		

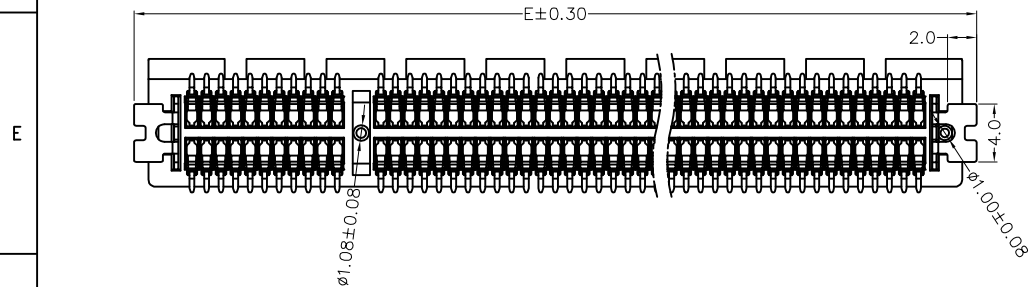

 THIRD ANGLE PROJECTION DESIGN UNITS METRIC(mm) SCALE 5:1 SIZE A4	GENERAL TOLERANCES (UNLESS SPECIFIED)		APPROVE BY LEO	DATE 20/JUL/24	PART NO. FPI10014-FXXS7XX5BKX	ITEM NO. FPI10014	 Building Technology Cornerstone REV 0 SHEET NO. 1/3
	X. ±0.30	X.* ±5°	CHECKED BY GISELLE	DATE 20/JUL/24	TITLE PCI Express Gen4(16GT/S) Pitch 1.0mm SMT(H11.25mm)		
	X.X ±0.20	X.X* ±2°	DRAWN BY MATT	DATE 20/JUL/24	THIS DRAWING CONTAINS INFORMATION THAT IS PROPRIETARY TO TXGA INDUSTRIAL ELECTRONICS(S.Z)CO.,LTD AND SHOULD NOT BE USED WITHOUT WRITTEN PERMISSION		

REV	LOCATIONS	DESCRIPTION	DATE	REVISER	APPD

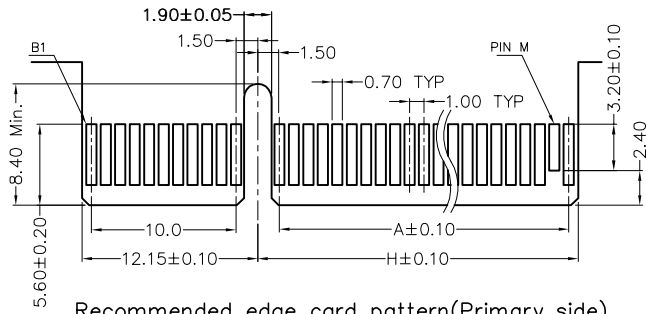

Recommended edge card pattern(Primary side)
General Tolerances: ±0.05mm

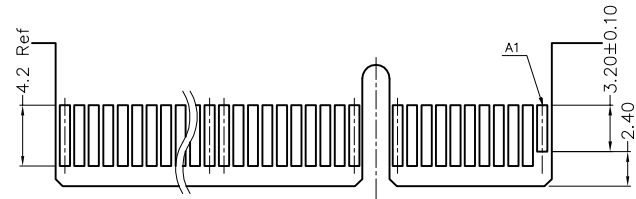
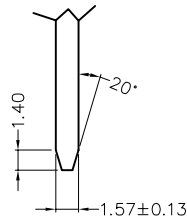

Recommended edge card pattern(Secondary side)
General Tolerances: ±0.05mm

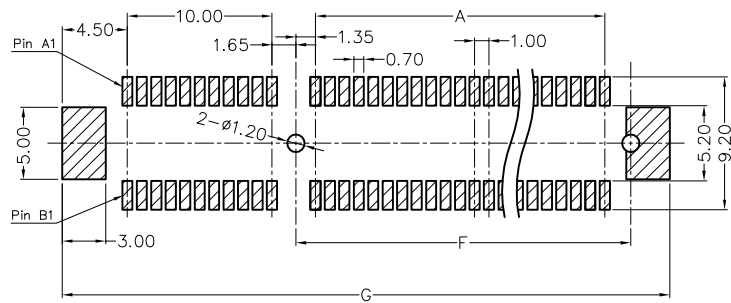

Recommended P.C.Board Layout
General Tolerances: ±0.05mm

Circuits(n)	Part No.	Dimensions (mm)								
		A	B	C	D	E	F	G	H	M
36	FPI10014-F36S7XX5BKX	6.0	7.65	9.15	25.0	27.0	9.15	28.0	8.15	B17
64	FPI10014-F64S7XX5BKX	20.0	21.65	23.15	39.0	41.0	23.15	42.0	22.15	B31
98	FPI10014-F98S7XX5BKX	37.0	38.65	40.15	56.0	58.0	40.15	59.0	39.15	B48
164	FPI10014-F164S7XX5BKX	70.0	71.65	73.15	89.0	91.0	73.15	92.0	72.15	B81

<p>THIRD ANGLE PROJECTION</p>	GENERAL TOLERANCES (UNLESS SPECIFIED)		APPROVE BY	DATE	PART NO.	ITEM NO.	<p>Building Technology Cornerstone</p>
	X. ±0.30	X.* ±5°	LEO	20/JUL/24	FPI10014-FXXS7XX5BKX	FPI10014	
	X.X ±0.20	X.X* ±2°	CHECKED BY	DATE	TITLE PCI Express Gen4(16GT/S) Pitch 1.0mm SMT(H11.25mm)		
	X.XX ±0.15	X.XX* ±1°	GISELLE	20/JUL/24	REV 0	SHEET NO. 2/3	
SCALE 5:1	SIZE A4	X.XXX ±0.10	X.XXX* ±0.5°	DRAWN BY	DATE	THIS DRAWING CONTAINS INFORMATION THAT IS PROPRIETARY TO TXGA INDUSTRIAL ELECTRONICS(S.Z)CO.,LTD AND SHOULD NOT BE USED WITHOUT WRITTEN PERMISSION	
				MATT	20/JUL/24		

1 2 3 4 5 6 7 8

REV	LOCATIONS	DESCRIPTION	DATE	REVISER	APPD

A

36POS

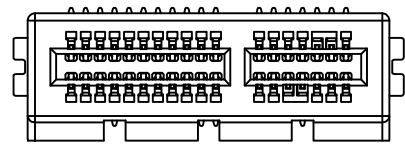

B

64POS

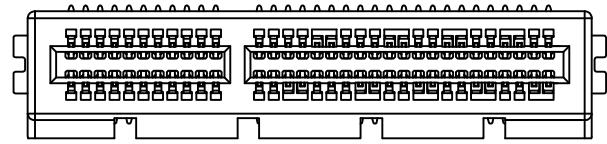

C

98POS

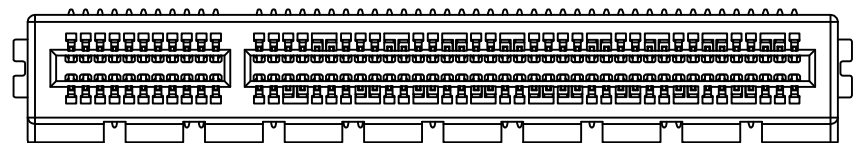

D

164POS

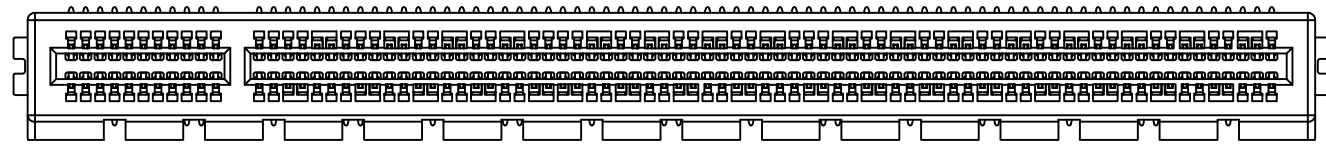

E

F

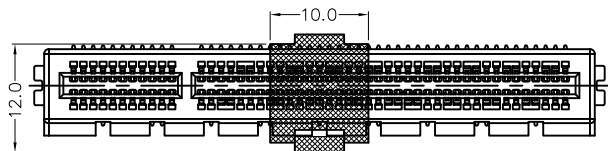

With CAP

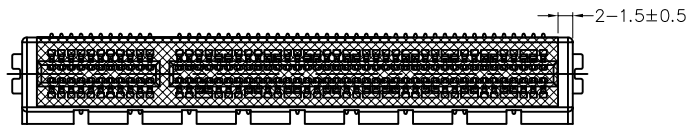

With Mylar

<p>THIRD ANGLE PROJECTION</p>	GENERAL TOLERANCES (UNLESS SPECIFIED)		APPROVE BY	DATE	PART NO.	ITEM NO.	<p>Building Technology Cornerstone</p>
	X. ±0.30	X.* ±5°	LEO	20/JUL/24	FP110014-FXXS7XX5BKX	FP110014	
	X.X ±0.20	X.X* ±2°	CHECKED BY	DATE	TITLE PCI Express Gen4(16GT/S) Pitch 1.0mm SMT(H11.25mm)		
	X.XX ±0.15	X.XX* ±1°	GISELLE	20/JUL/24	REV 0	SHEET NO. 3/3	
SCALE 5:1	SIZE A4	X.XXX ±0.10	X.XXX* ±0.5°	DRAWN BY	DATE	THIS DRAWING CONTAINS INFORMATION THAT IS PROPRIETARY TO TXGA INDUSTRIAL ELECTRONICS(S.Z)CO.,LTD AND SHOULD NOT BE USED WITHOUT WRITTEN PERMISSION	
			MATT	20/JUL/24			

1 2 3 4 5 6 7 8